

Notes: Find and Replace

RURAL TECHNOLOGY CENTERS to RTC

*Clue4: key Word is **RURAL TECHNOLOGY CENTER***

After find and replace please don't save this file.

Students hints:

1. Find and Replace pane with the keyboard **RURAL TECHNOLOGY CENTER**. (Ctrl+f or Ctrl+h)
CONTROL + F or CONTROL + H

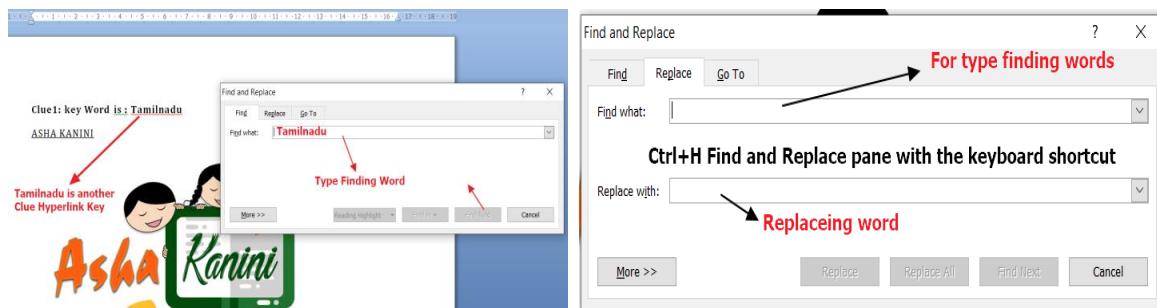

2. Following Hyperlink key word Ctrl+ Mouse left click than Open (*****.jpg) image.

See the next page

ASHA RURAL TECHNOLOGY CENTER



*Asha for Education, Chennai has formed a partnership
with Pravartak (subsidiary of IIT Madras)
to establish 3 RURAL TECHNOLOGY CENTERS in **Thiruvallur**
District.*

We hope to expand these to many more centres over time.

PROBLEM



Technology affects almost every aspect of life in today's world. Access to healthcare, paying for services, information about farming, traveling using maps are all made easier with technology. However, access to quality technical education is sadly lacking in our villages in India, since the personal technical resources are expensive and there is a dearth of technical skills in these villages to impart knowledge. The current computer science curriculum in high schools is too broad and the impetus to complete the curriculum creates an environment where the ability for the student to understand the material and use it effectively is sacrificed.

SOLUTION

Asha has been working with elementary and middle schools since 2015 to educate students in both digital literacy and

computational thinking. Asha has used advanced block based programming tools like Scratch from MIT and Blockly from Google to teach programming. These tools are so easy to use that the middle school students have both mastered these in a few short weeks and shown tremendous enthusiasm in learning. Asha expects to build on this expertise by using proven methodologies like the curriculum from code.org that have been used and tested in other countries successfully. We also intend to use IIT's experience and expertise in quality technical education.



RURAL TECHNOLOGY CENTERS